

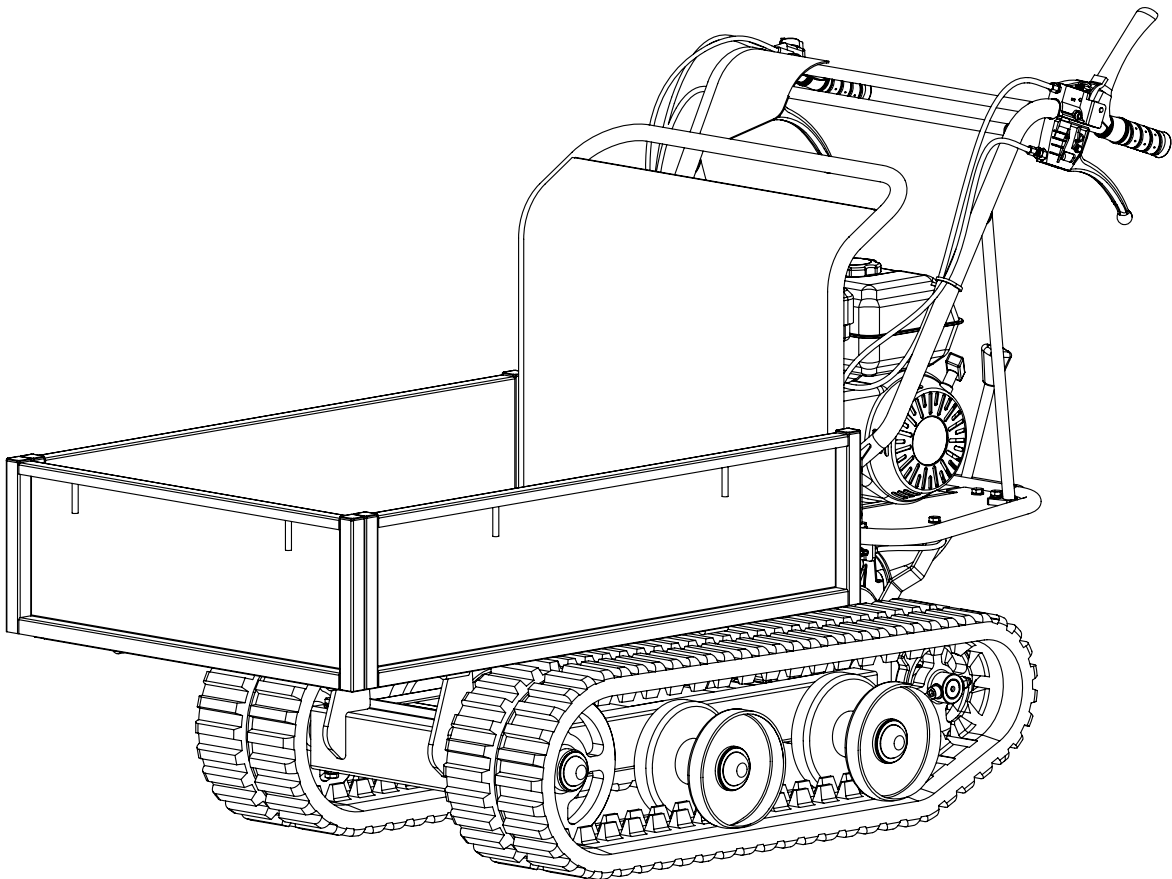

All Terrain Power Cart



MODEL # 101872

Operation Manual



This safety alert symbol identifies important safety messages in this manual. Failure to follow this important safety information may result in serious injury or death.

Part # 101873 Rev C



For Service or Questions

Call 1-877-487-8275

720-287-5182

www.dirtyhandtools.com

Dirty Hand Tools® is a brand of



1100 W 120th Ave, Suite 600
Westminster, CO 80234 • 720-287-5182

Table of Contents

Important Safety Information

Intended Use	4
Personal Protective Equipment	4
General Safety	5
Safety Decals	6
Unpacking	7
Assembly.....	8
Components	12
Operation Controls.....	13
Filling with Gasoline and Oil.....	14
Operation	15
Maintenance	18
Troubleshooting.....	22
Storage.....	23
Warranty & Specifications	Back Cover

Important Safety Information



WARNING

WARNING: Read and thoroughly understand all instructions and safety information before assembling or operating this All Terrain Power Cart. Failure to do so may cause serious injury or death. Do not allow anyone to operate this equipment who has not read this manual. As with all power equipment, an All Terrain Power Cart can be dangerous if assembled or used improperly. Do not operate this equipment if you have doubts or questions concerning safe operation.



Call our customer service department at **720-287-5182**, **1-877-487-8275**, or visit www.dirtyhandtools.com if you have any questions or concerns about the safe operation of this equipment.



DANGER

Intended Use

Do Not Use the Power Cart for any purpose other than for which it was designed. Any other use is unauthorized and may result in serious injury or death.

Personal Protective Equipment

When operating this Power Cart it is essential that you wear safety gear including goggles or safety glasses, adequate clothing and tight fitting gloves (no loose cuffs or draw strings). Always wear ear plugs or sound deafening headphones to protect against hearing loss when operating this Power Cart. Always wear sturdy footwear. Never wear sandals, sneakers or open shoes, and never operate the Power Cart with bare feet. Do not wear loose clothing that might get caught in moving parts.



CAUTION

Whenever you leave the operating position to unload or make adjustments always shut off the engine and wait five (5) minutes to allow parts to cool. Remove the key or disconnect the spark plug wire and keep the wire away from the spark plug to prevent accidental starting.



CALIFORNIA PROPOSITION 65 WARNING

Engine exhaust, some of its constituents and certain product components contain or emit chemicals known to the state of California to cause cancer and birth defects or other reproductive harm.



Important Safety Information

General Safety

Failure to follow warnings, cautions, assembly and operation instructions in the Operation Manual may result in serious injury or death.



DANGER

READ THE OPERATION MANUAL BEFORE OPERATION.

- **Do not** permit children to operate this equipment at any time. Do not permit others that have not read and understood the complete Operation Manual to operate this equipment.
- Keep all people and pets away from the work area when operating the Power Cart.
- **Do not** operate the Power Cart when under the influence of alcohol, drugs or medication.
- **Do not** allow a person who is tired or otherwise impaired or not completely alert to operate the Power Cart.



DANGER

CAREFULLY INSPECT THE AREA TO BE TRIMMED AND REMOVE ALL FOREIGN OBJECTS.

- Always operate the Power Cart from the control panel.
- Never stand or sit on the machine with engine running.
- Always turn the engine off when unloading.
- Never, under any conditions, remove, bend, cut, fit, weld, or otherwise alter standard parts on the Power Cart.
- Use caution when operating on slopes.
- Do not operate on slopes greater than 20 degrees.
- Be cautious when using the Power Cart around obstacles such as fencing, wires, ropes, or other material that can become entangled within the Power Cart's tracks.
- Do not exceed the recommended load limit of 705 lbs.

Important Safety Information

- Never run the engine in an enclosed area or without proper ventilation as the exhaust from the engine contains carbon monoxide, which is an odorless, tasteless, and deadly poisonous gas.
- Fill the gasoline tank outdoors with the engine off and allow the engine to cool completely.
- Do not operate the engine with the air cleaner or cover over the carburetor air-intake removed, except for adjustment. Removal of such parts could create a fire hazard.
- The muffler and engine become very hot with use and can cause a severe burn; do not touch. Allow the engine to cool before refueling, doing maintenance, or making adjustments.

Safety Decals

Safety labels on the Power Cart are to remind you of important information while you are operating the unit. Make sure all safety warning decals are attached and in readable condition. Replace missing or defaced decals. Contact Dirty Hand Tools at 1-877-487-8275 for replacement decals.



WARNING

This product can expose you to chemicals including CARBON MONOXIDE, which is known to the State of California to cause cancer. For more information go to www.P65Warnings.ca.gov.

108275

WARNING

This product can expose you to chemicals including CARBON MONOXIDE, which is known to the State of California to cause cancer and birth defects or other reproductive harm. For more information go to www.P65Warnings.ca.gov.

108276

OPERATE STEERING LEVERS AT REDUCED SPEED ONLY

STOP

RUN

Unpacking

1. Remove the screws on the top of the container and set lid aside.
2. Remove the packing materials and contents.
3. Remove the end of the container and walk the Main Power Cart Assembly out of the container and onto a level surface.

Contents

1. Main Power Cart Assembly with engine
2. Handlebar Assembly
3. Tipping Handle
4. Extendable Side
5. Engine Guard
6. Extendable Side
7. Bottom Panel
8. Rear panel
9. Operation Manual
10. Hardware

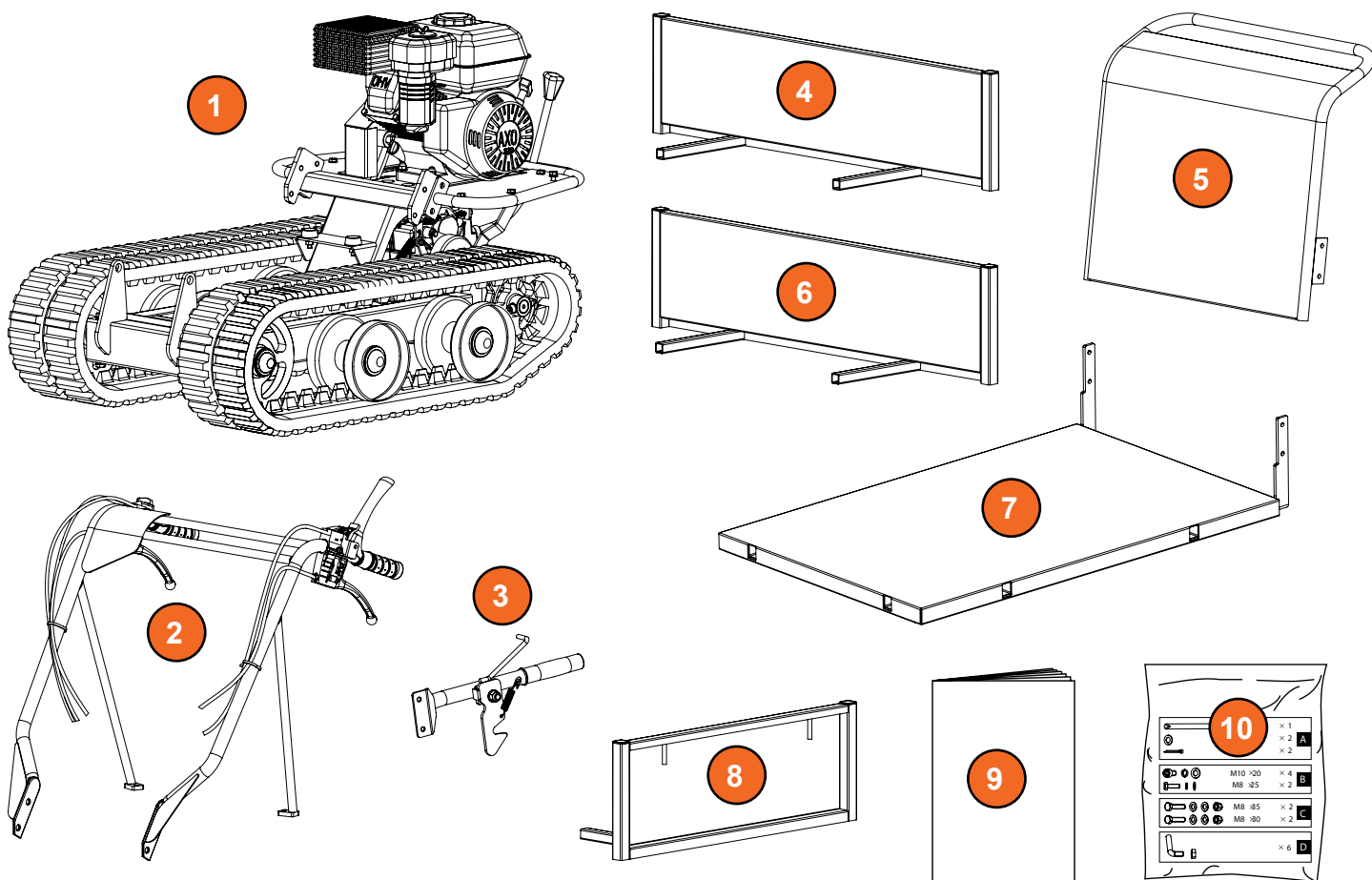

Assembly

Mounting the Bottom Panel to the Power Cart

Position the bottom panel inside of the mounting bracket. Align the holes through the mounting bracket and insert the long retaining pin through the holes. Secure with a flat washer and a cotter pin at either end.

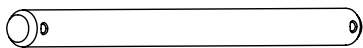
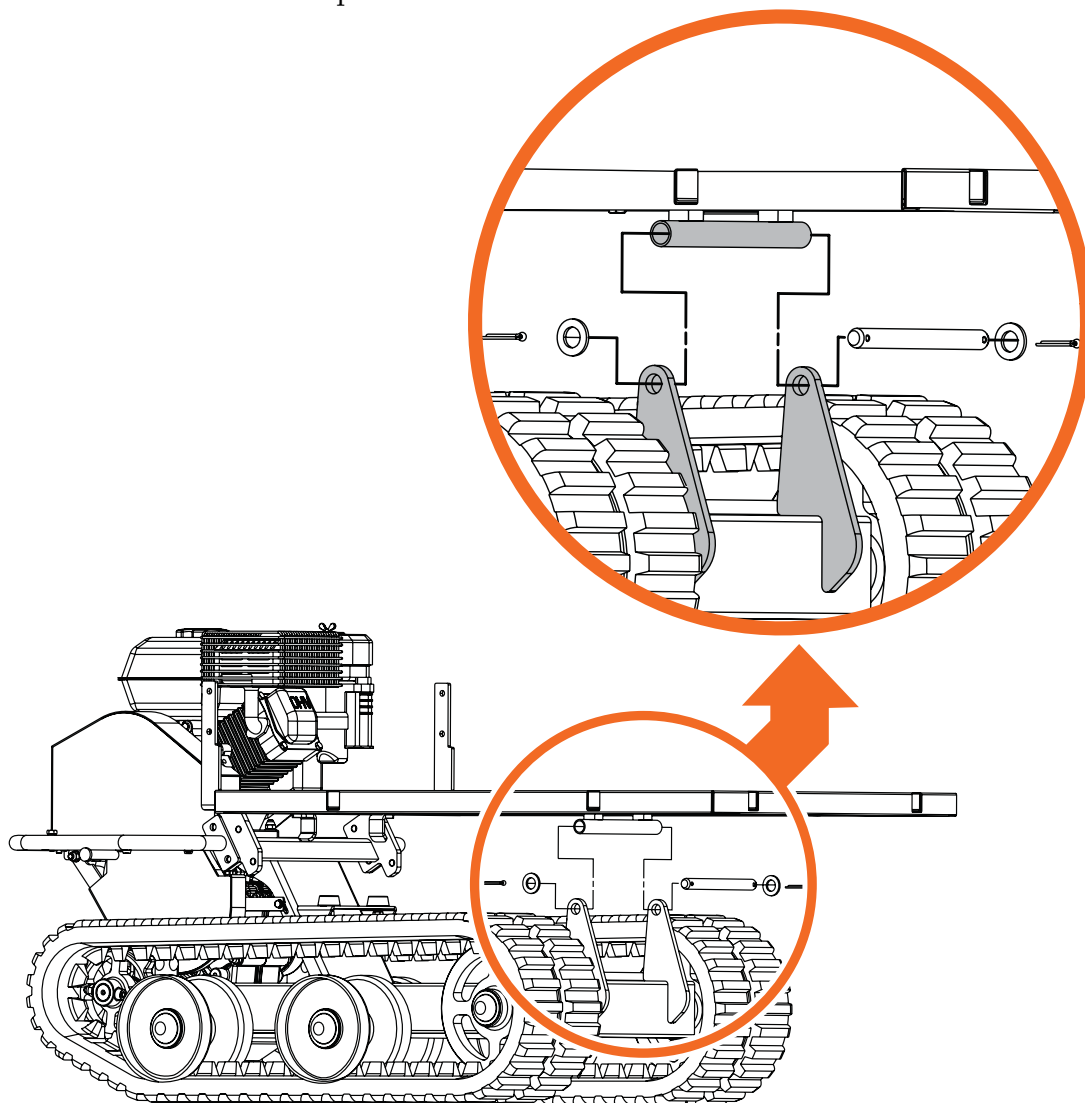

Retaining Pin, 16mm dia. x 238mm (1 qty.)



Flat Washer, 16mm (2 qty.)



Cotter Pin, 4mm x 35mm (2 qty.)

Assembly

Mounting the Handlebars to the Power Cart

Align the holes in the handlebar assembly with the holes in the mounting bracket on the Power Cart. Secure each side with a lock washer, flat washer and M10 x 20mm socket head bolt.

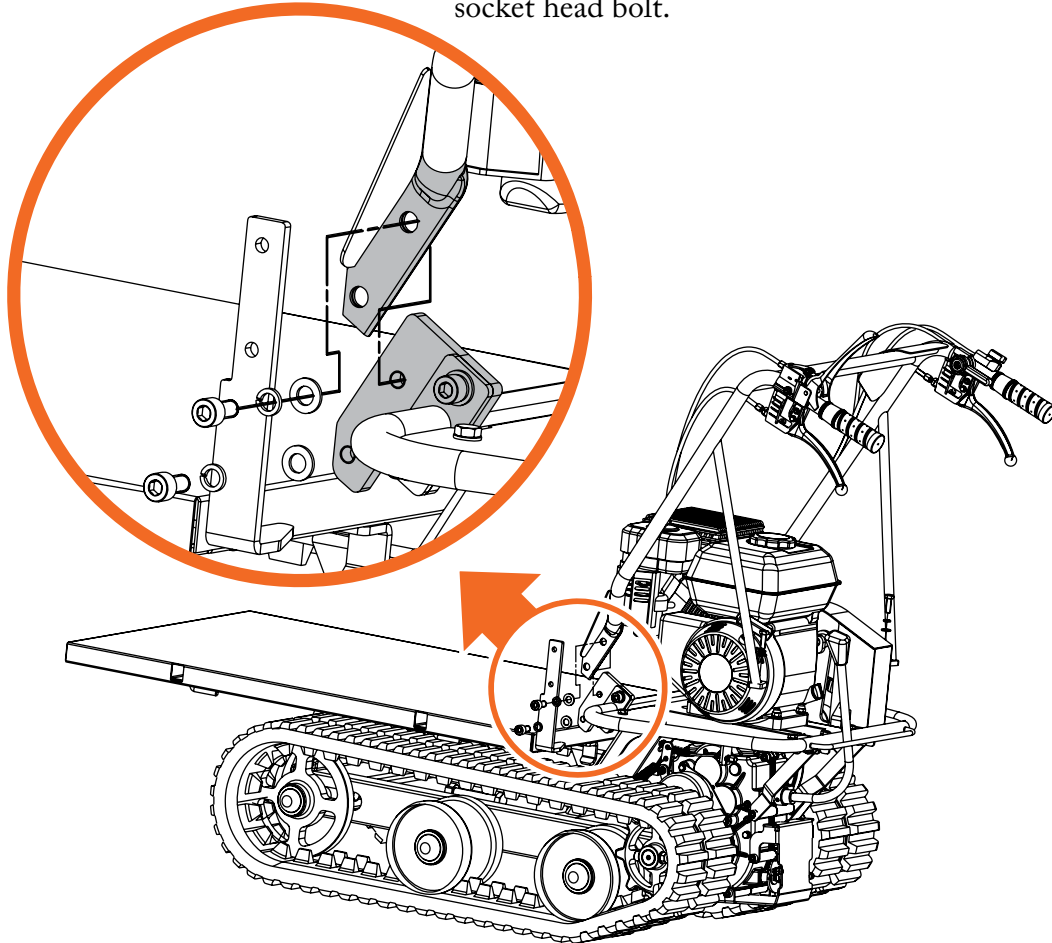

Socket Head Bolt, M10 x 20mm (4 qty.)



Lock Washer, M10 (4 qty.)



Flat Washer, M10 (4 qty.)

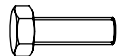

Hex Bolt, M8 x 25mm (2 qty.)



Lock Washer, M8 (2 qty.)



Flat Washer, M8 (2 qty.)

Assembly

Mounting the Engine Guard to the Power Cart

Place the engine guard inside of the mounting bracket aligning the holes in each. Secure the left side with two M8 x 30mm hex bolts, four washers and two hex nuts.

Mounting the Tipping Handle to the Power Cart

Mount the tipping handle on the right hand side aligning with the holes in the mounting bracket. Secure with two M8 x 35 mm hex bolts, four washers and two hex nuts.

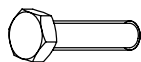
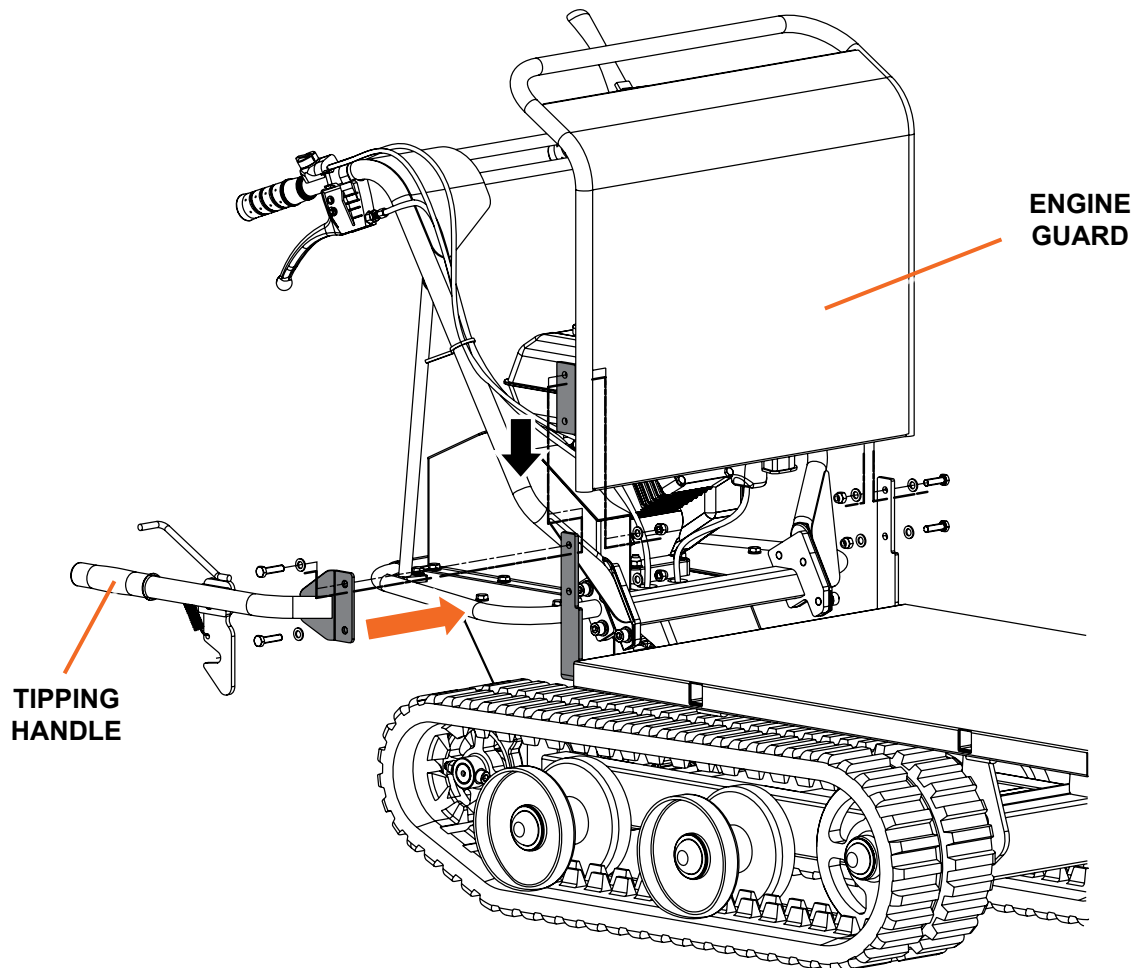

Hex Bolt, M8 x 35mm (2 qty.)



Flat Washer, M8 (2 qty.)



Hex Nut, M8 (2 qty.)

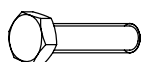

Hex Bolt, M8 x 30mm (2 qty.)



Lock Washer, M8 (2 qty.)



Flat Washer, M8 (2 qty.)

Assembly

Mounting the Extendable Side Panels to the Power Cart

Insert the extendable side panels into the mounting slots on the bottom panel and secure with L-Retaining pins and lock nuts in six places

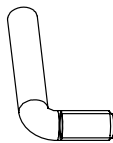
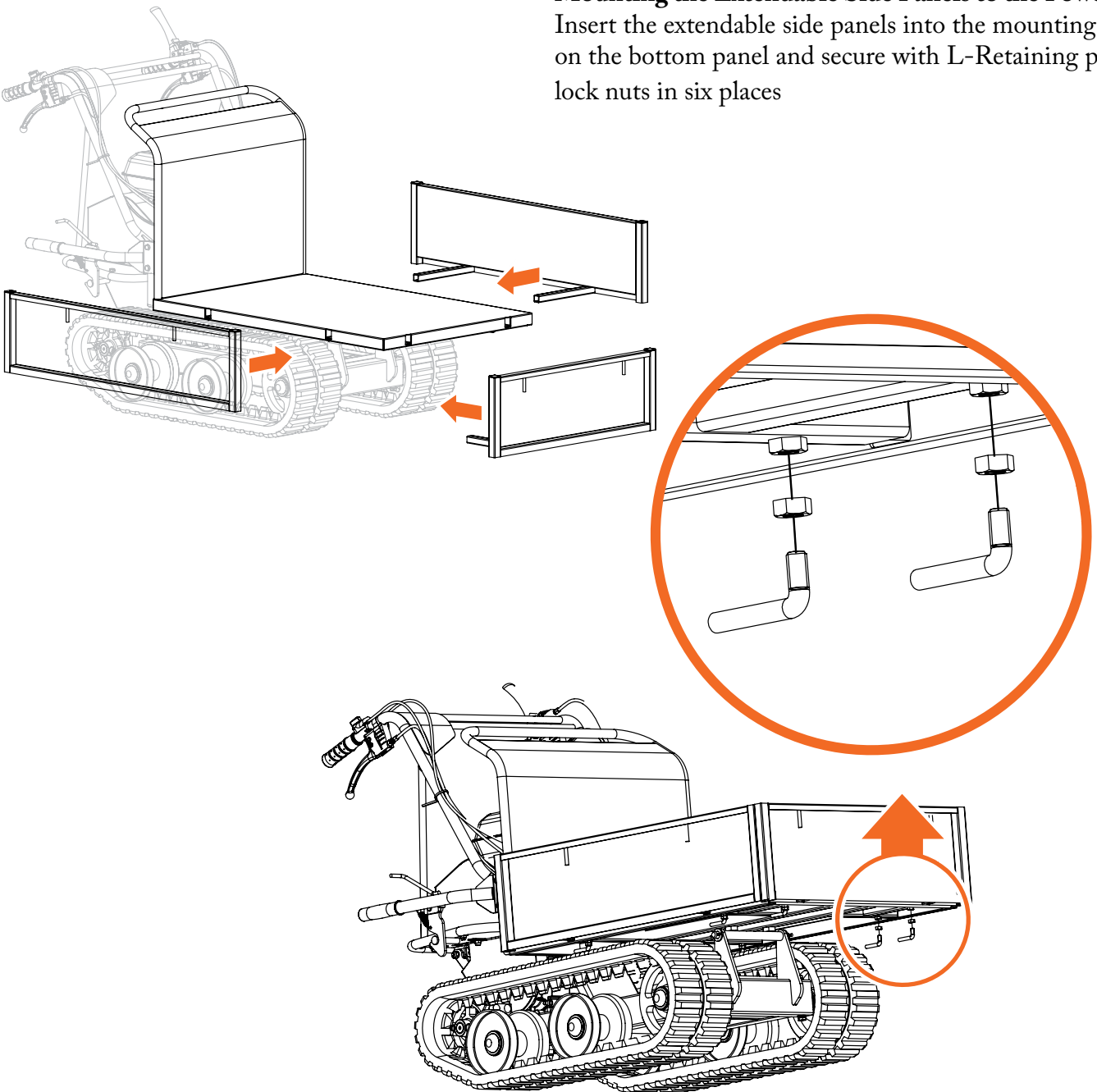

L -Retaining Pin (6 qty.)



Lock Nut (6 qty.)

Components

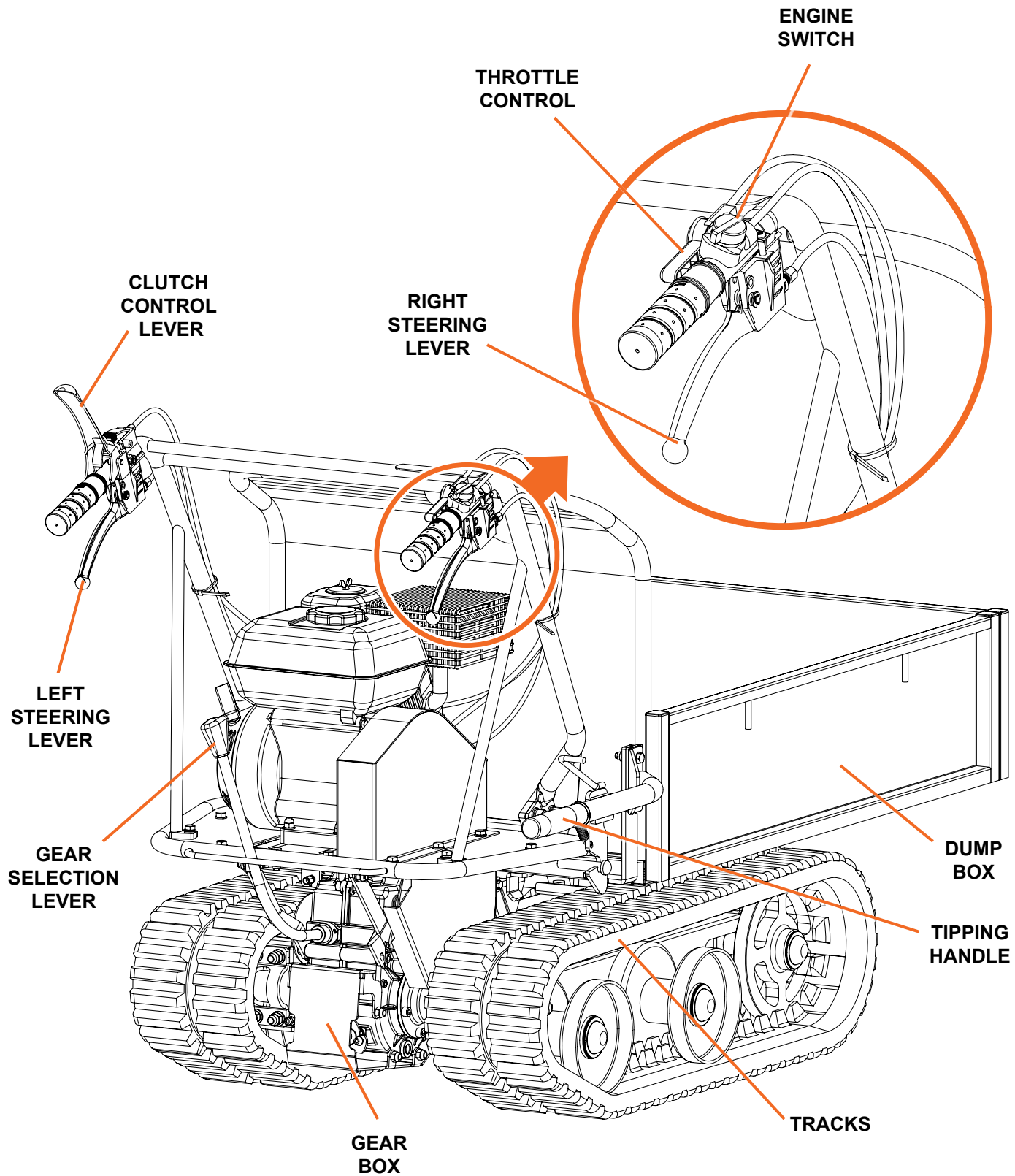

Operation Controls

Engine Switch

The engine switch must be in the on position for the engine to start and run.

Throttle Control

The throttle controls the speed of the engine and can be adjusted between low (L) and high (H).

Clutch Control Lever

Squeeze the clutch control to engage the clutch, release the lever to disengage the clutch.

Left Steering Lever

Depress the lever to turn to the left.

Right Steering Lever

Depress the lever to turn to the right.

Gear Selection Lever

Controls the forward or reverse movement of the Power Cart. The Power Cart has three forward gears and one reverse gear.

Tipping Handle

Control the tipping of the dump cart. Pull the tipping handle up to release the dump box's locking device and to raise the dump box. When the dump box is lowered completely down towards the Power Cart the locking mechanism automatically engages on the tipping handle to lock the dump box in place to prevent dumping.

Filling with Gasoline and Oil



WARNING

ADD OIL BEFORE STARTING THE ENGINE
The Power Cart is shipped without fluids installed.

Keep the caps on the fuel and oil fills until you are ready to pour either gasoline or oil into the correct fill.

Requires approximately 20 ounces of SAE 10W30 engine oil.

1. Place the machine on a level surface and initially add 1/2 of the SAE 10W30 high detergent oil into the oil fill and wait one minute for the oil to settle.
2. Check the dipstick and continue adding a few ounces of oil at a time, rechecking the dipstick until the oil reaches the fill mark. Be careful not to overfill.
3. Fill the fuel tank with fresh, unleaded gas (85+ Octane), to 1/2" from the top of the fill neck to allow for expansion. Be careful not to overfill and reinstall the cap before starting the engine.



WARNING

ALWAYS FILL THE TANK WITH
ENGINE OFF AND COOL.

ALWAYS CHECK THE OIL LEVEL
BEFORE OPERATING.

Allow the engine to cool for at least two minutes before removing the fuel cap. Use caution as engine oil, muffler and other components may be hot to the touch. To avoid fire danger never add fuel to a hot engine.

Before performing any adjustments to the Power Cart or any maintenance, stop the engine, wait five minutes to allow parts to cool. Disconnect the spark plug wire, keeping it away from the spark plug. Contact with internal rotating parts may cause serious personal injury. Never put hands or feet on or between the track rollers.

SAE VISCOSITY GRADES

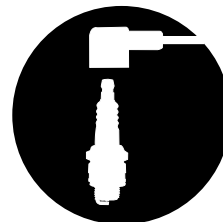
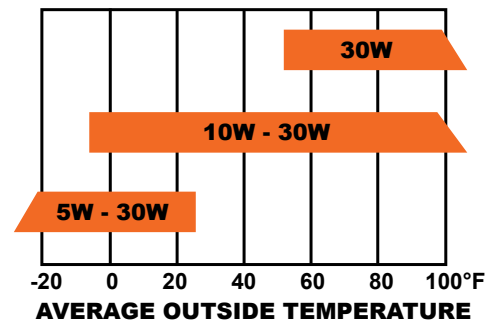

Operation

Starting the Engine

A more detailed description of the engine operation and all related precautions and procedures can be found in the Engine Manual packed separately with the Power Cart.

Follow the procedure below for cold starts:

1. Turn choke lever on the engine to the CLOSED position.
2. Set the throttle lever on the handlebar at halfway position.
3. Turn the engine switch on.
4. Pull the starting rope slowly several times to allow the gasoline to flow into the engine's carburetor. Then hold the start handle firmly and pull rope out a short distance until you feel some resistance. Then pull the rope smoothly and briskly, and allow rope to return gently. Do not let the rope snap back. If necessary, pull the rope several times until the engine starts.
5. Allow the engine to run for several seconds to warm up. Then, gradually move choke lever to "OPEN" position.

Restarting a warm engine does not require use of the choke, so follow the same steps above with the choke lever set to the OPEN position.

Stopping the Engine

To stop the engine in an emergency, simply turn the engine switch to the OFF position. Under normal conditions, use the following procedure.

1. Move the throttle lever to the SLOW position.
2. Let engine idle for one or two minutes.
3. Turn the engine switch to the OFF position.
4. Turn the fuel valve lever to the OFF position.



CAUTION

**Do not move the choke control to stop the engine.
This may result in engine backfire or
damage to the engine may occur.**

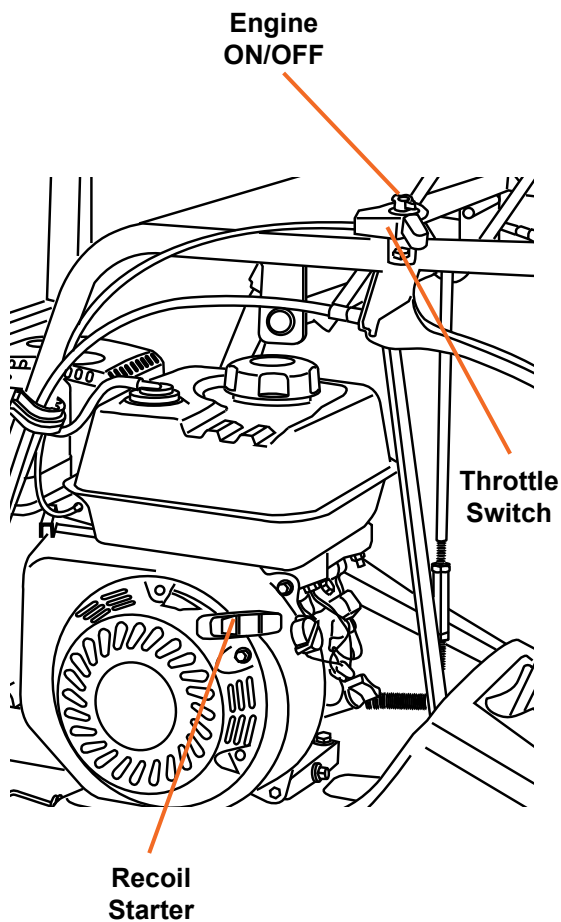

Operation

Operating

After engine warms up, pull throttle lever to accelerate engine speed. Engage the required gear and slowly squeeze the clutch control lever. If the gear does not engage right away, slowly release the clutch lever and try again.

Changing Directions

1. To turn left, pull the left steering lever upwards.
2. To turn right, pull the right steering lever upwards.

The sensitivity of the steering increases in proportion to the speed of the machine and that with an empty machine, a light pressure on the lever is all that is needed to turn. When the machine is loaded, more pressure is required.



CAUTION

It is recommended that the operator practice driving the Power Cart with the dumper empty to become familiar with the equipment's operation before attempting to move a load.



DANGER

The Power Cart's maximum capacity is 700 lbs. (317.5 kg).

**To avoid tipping over when operating
on a slope use the lowest gear.**

Never operate on a slope greater than 20 degrees.

Avoid sharp turns and frequent changes of direction particularly on rough, hard terrains. Use caution when working in adverse weather conditions (ice, heavy rain and snow) or on types of ground that could make the Power Cart unstable.

Note that as this is a tracked vehicle, it is subject to a considerable pitching movement when passing over bumps, holes and steps. If the machine is stopped on a steep slope, a block should be placed against one of the tracks.

When the clutch control lever is released, the machine will stop and brake automatically.

Operation



DANGER

**NEVER load or unload the Power Cart
while the engine is running.**

A strong impact in the bucket could accidentally engage the transmission, setting the Power Cart into motion.

Loading and Unloading

1. Position the Power Cart into the desired position for dumping the load.
2. Turn off the engine and put the clutch lever into the STOP position.
3. Pull the tipping handle up to release the dump box's locking device and raise the dump box.
4. Raise the dump box manually to dump the load.
5. Pull the tipping handle down to its original position.
When the dump box is lowered, the locking mechanism operates, locking the dump box.

Maintenance



WARNING

TURN OFF ENGINE AND DETACH SPARK PLUG WIRE.

Allow engine to cool before performing maintenance.

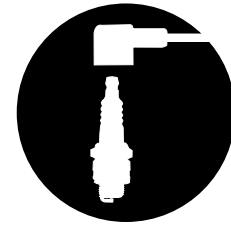

Check the Power Cart for loose screws, misalignment or binding of moving parts, cracked or broken parts, and any condition that may affect safe operation. Remove debris and other materials that may have accumulated in and around the tracks. Clean after each use. Use a premium lightweight machine oil to lubricate moving parts.



CAUTION

**Do not use a “pressure washer” to clean the Power Cart.
Water can penetrate the machine and its transmission case and
cause damage to spindles, gears, bearings or the engine.**

Transmission

The gearbox is pre-lubricated and sealed at the factory. Check oil level every 50 hours of working. Use portable tool lithium #0 grease such as Lubriplate 6300AA , Lubriplate GR-132, or Multifak,e.g. EP-O.

Changing the Engine Oil

Oil should be changed when warm by unscrewing filler cap and draining into a suitable container for disposal. When oil is completely drained, replace filler cap and fill with standard SAE10W30 engine oil.

Adjusting the Clutch Lever

As the clutch wears out, the lever could have a wider opening, making it difficult to use. Adjust the cable, setting the clutch lever to its original position using the adjustment device and counter-nut.

Adjusting the Steering Levers

If steering the unit becomes difficult, adjust the steering levers with the special adjusters. Loosen the locknut and unscrew the adjuster to eliminate the play in the cable, which can occur with normal wear. Be careful not to unscrew the adjusters too much because this can create the loss of traction. Tighten the locknut when finished.



Maintenance

Adjusting the Tracks

With use, tracks tend to loosen on the drive wheels. Operating with loose tracks can cause them to slip over the driving wheel causing it to jump its housing and cause damage.

1. To check track tightness set the Power Cart on a flat, compact surface. Lift the machine and set it on blocks or supports so that the tracks are approximately 4" (100mm) off of the ground.
2. Measure the sag in the tracks, by measuring the height from the ground to the middle of the top track. Compare this with measuring the distance from the ground to the top of the track on the top of the wheel. The difference in the distance should not exceed 0.4" - 0.6" (10 - 15mm). If the distance is greater, use the tipping handle to tip the dump box and set it on blocks that support the weight of the Power Cart.
3. Loosen locknut A. Tighten bolt B until the correct tightness is restored. Secure bolt B by tightening locknut A thoroughly. Return the dump box to its original position.

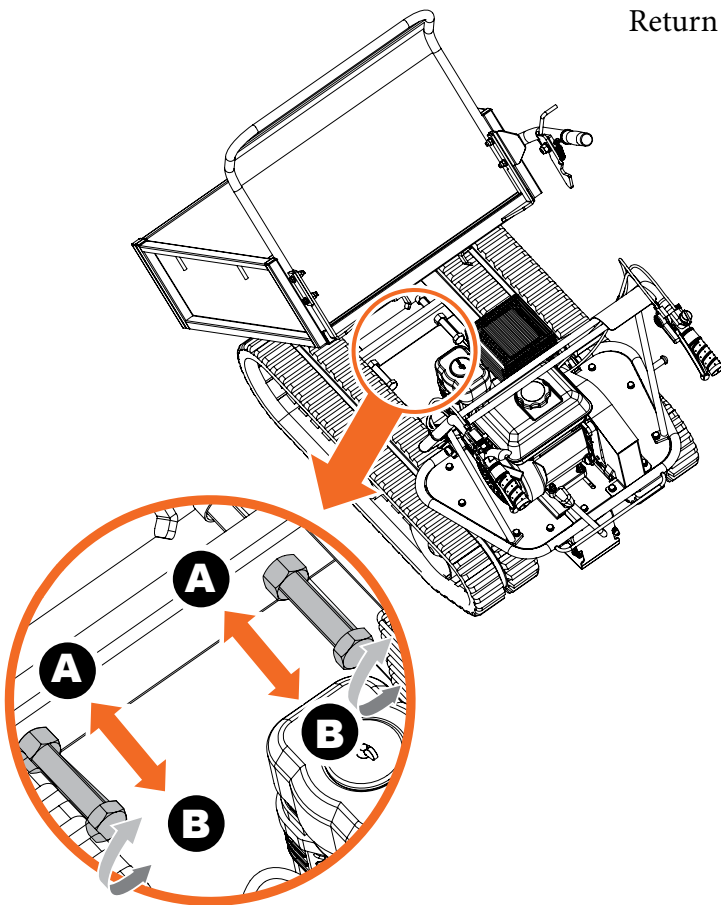

CAUTION

LIFTING THE POWER CART REQUIRES TWO PEOPLE

The adjustment of the track and the brakes are linked, therefore be careful to not over-tighten the track causing the loss of braking ability.

If the adjustment bolt has no more adjustment left, the tracks may have to be replaced.

Maintenance

Replacing tracks

Check the condition of the tracks periodically. If a track is cracked or frayed, it should be replaced as soon as convenient.

1. Loosen the locknut A and bolt B shown in Adjusting the Tracks, (page 19) to allow the tracks to be loose enough.
2. Slip the old tracks off and install the new tracks.
3. Adjust bolt B to assure correct tightness.
4. Secure bolt B by tightening locknut A thoroughly.



CAUTION

When removing or installing the tracks, use caution to avoid having fingers caught between the track and pulley.

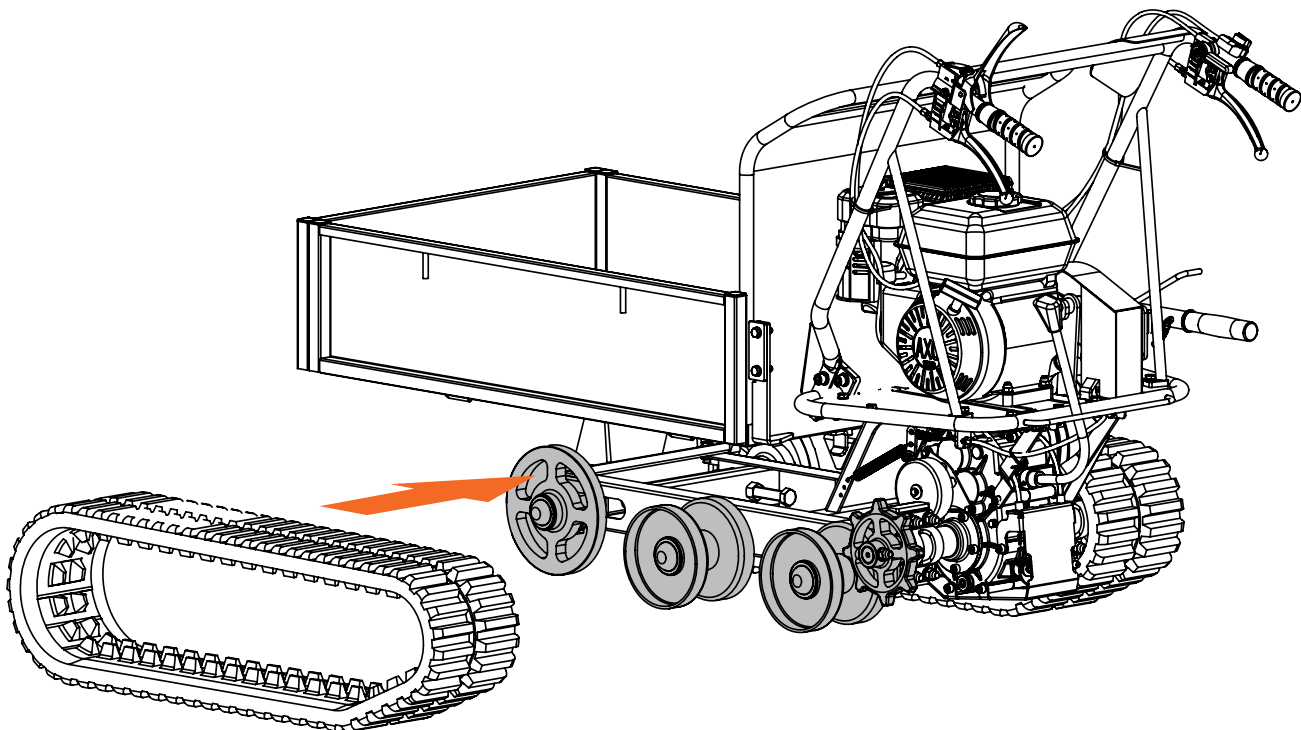

Maintenance

Engine Maintenance

1. Check oil level before each use and after 8 hours of operation.
2. Change oil after first 5-8 hours of operation. Change oil while engine is warm. Refill with new oil of recommended grade.
4. Check spark plug yearly or every 100 hours of operation.
5. Service air cleaner.
6. Keep engine and parts clean.
7. Check engine and equipment often for loose nuts and bolts.

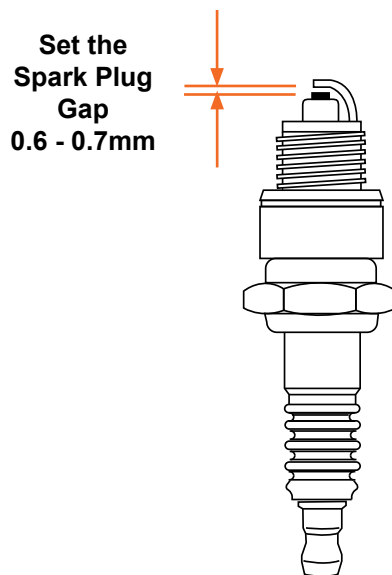
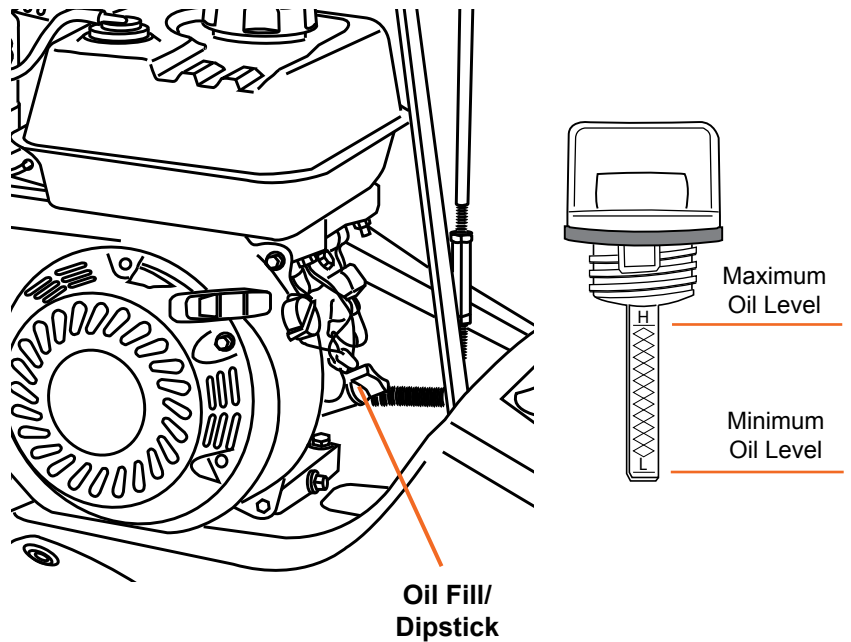

Troubleshooting

PROBLEM	SOLUTION
Engine will not start	<ul style="list-style-type: none"> • Add gas to gas tank • Connect spark plug wire to spark plug • Throttle must be positioned in the middle • Choke lever must be CLOSED to start cold engine • Fuel line is clogged, remove, clean and replace
Engine runs rough, floods during operation	<ul style="list-style-type: none"> • Clean or replace air cleaner
Engine is hard to start	<ul style="list-style-type: none"> • Drain old fuel and replace with fresh. Use gas stabilizer at end of season • Make sure spark plug wire is securely attached to plug • Move the throttle to the left
Engine misses or lacks power	<ul style="list-style-type: none"> • Remove and clean fuel tank • Clean or replace air cleaner • Improper carburetor adjustment, take to authorized engine service center • Replace spark plug and adjust gap • Drain and refill gas tank and carburetor
Engine stops suddenly	<ul style="list-style-type: none"> • Low quality or deteriorated gasoline, drain and replace • Spark plug wire damaged or loose • Defective fuel cap creating a vacuum • Improper idle speed, move throttle to the right
Engine Overheats	<ul style="list-style-type: none"> • Engine oil is too low, check dipstick and add oil • Dirty air filter, clean and replace
Engine stalls when shifting transmission gears	<ul style="list-style-type: none"> • Release clutch lever before shifting gears
Power Cart moves forward during starting	<ul style="list-style-type: none"> • Clutch lever must be released
Power Cart is not braking properly or is hard to turn	<ul style="list-style-type: none"> • The steering lever(s) need adjustment (see page 18) • The brake(s) are wet, allow the brakes to dry • The dump box is overloaded, reduce the load
The Power Cart's track has slipped off	<ul style="list-style-type: none"> • Adjust the track tension (see page 19) • Replace the track if it is broken or excessively worn
Power Cart moves too slowly	<ul style="list-style-type: none"> • Reduce the load • Put transmission into a higher gear
Power Cart does not move with the engine running	<ul style="list-style-type: none"> • Make sure that the transmission is not between gears • Tracks are not tight enough, stop engine and adjust track tension (see page 19)

Storage

To store the Power Cart for an extended period:

1. Drain the fuel tank completely. Stored fuel containing ethanol or MTBE can start to go stale in 30 days. Stale fuel has high gum content and can clog the carburetor and restrict fuel flow. Start the engine and allow it to run until it stops. This ensures no fuel is left in the carburetor.
2. While the engine is still warm, drain the oil from the engine. Refill with fresh oil of the grade recommended in the Engine Manual.
3. Use a clean cloth to clean off the outside of the machine and to keep the air vents free of obstruction.
4. Inspect for any loose or damaged parts. Repair or replace damaged parts and tighten loose screws, nuts or bolts.
5. Store your unit on flat ground in a clean, dry building that has good ventilation.
6. Do not use strong detergents or petroleum based cleaners when cleaning plastic parts. Chemicals can damage plastics.



CAUTION

Do not store the Power Cart with fuel in a non-ventilated area where fuel fumes may reach flame, sparks, pilot lights or ignition sources.

Warranty & Specifications

IMPORTANT NOTICE

We, the manufacturer, reserve the right to change the product and/or specifications in this manual without notification. The manual is for information usage only and the pictures and drawings depicted herein are for reference only.

Warranty Repair and Service

Do not return this product to the store for warranty issues or repair. Call our customer service department at **720-287-5182, 1-877-487-8275**, or visit www.dirtyhandtools.com for the location of the nearest service center.

Record the information below for future reference.

Model No. _____

Serial No. _____

Date of Purchase _____

Place of Purchase _____

Specifications

SKU/Part No.	101872
Description	All Terrain Power Cart
Engine	6.5 HP /196cc Engine* EPA/50 State Approved
Engine Fuel Capacity	0.95 gallons (3.6 liters)
Engine Oil Capacity	20.3 ounces (0.6 liters)
Transmission	3 Forward Speeds /1 Reverse Speed
Load Capacity	700 Lbs. (317.5 kg)
Cargo Dimensions	36"L x 24"W x 8" H
Tracks	7" Width
Dumping	Manually up to 60° angle
Dimensions	44.7"L x 29.5"W x 29.5" H
Weight	392.4 Lbs. (178 kg)
Warranty	2 Year / 2 Year Limited Warranty

*As rated by engine manufacturer

** Not included, shipped without engine oil

Dirty Hand Tools® is a brand of
 **FrictionlessWorld**
1100 W 120th Ave., Suite 600
Westminster, CO 80234 • 720-287-5182

For Service or Questions
Call 1-877-487-8275
720-287-5182
www.dirtyhandtools.com