



Quick Assembly Guide-30 Inch Snow Blower

Models #103879 & 103880

Handlebar and Shift Control Assembly

1. Carriage bolts, curved washers and nylon lock nuts have been provided in a hardware package. Align the two holes in the handlebar connector block with the two holes in the upper and lower handlebars assemblies on the snow blower. Push carriage bolts through from the outside and secure with a curved washer and nylon lock nut on the interior in two places on both sides of the snow blower. Tighten securely (see Figure 1).
2. Attach the drive wire on the left side of the snow blower (see Figure 2). Remove the R-clip that connects the drive wire to the control lever on the handlebars, then slip the wire off. Attach the other end of the drive wire with the spring mechanism to the connection ring and reattach the drive wire to the control lever reinserting the R-clip. After connecting the wire adjust the tension. The wire should be taught when connected. (See Control Wire Adjustment, page 23 in the Operation Manual).
3. Attach the auger wire on the right side of the snow blower (see Figure 3). Remove the R-clip that connects the auger wire to the control lever on the handlebars, then slip the wire off. Attach the other end of the auger wire with the spring mechanism to the connection and reattach the auger wire to the control lever reinserting the R-clip. After connecting the wire adjust the tension. The wire should be taught when connected. (See Control Wire Adjustment, page 23 in the Operation Manual).
4. Attach the gear shift rod to the rocker arm on the under side of the control panel and secure with a cotter pin (see Figure 4).
5. Attach the other end of the gear shift control rod to the rocker arm on the rear of the snow blower (see Figure 5). Pass the attachment bolt on the control rod through the hole in the rocker arm and secure with a nylon lock nut.
6. Attach the wire harness for heated handle control to the harness coming off of the engine.

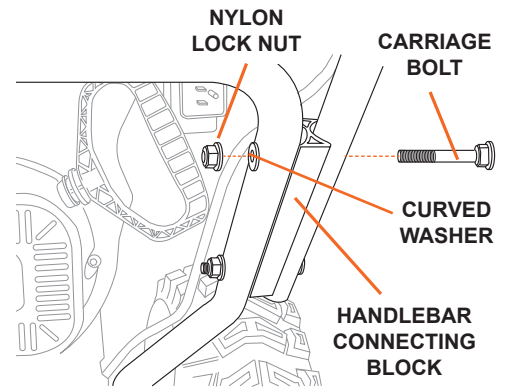

Figure 1

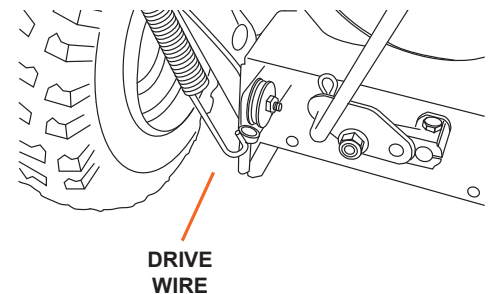

Figure 2

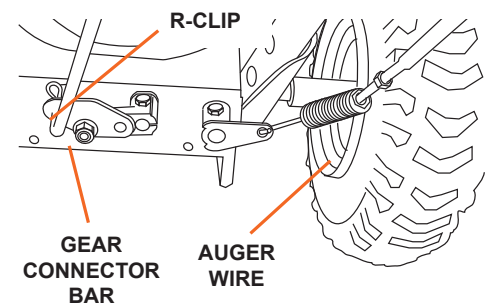

Figure 3

Attaching the Shift Lever Handles

1. Thread the shift lever handles on to the shift lever rods, one for the speed shift and one for the discharge height control.

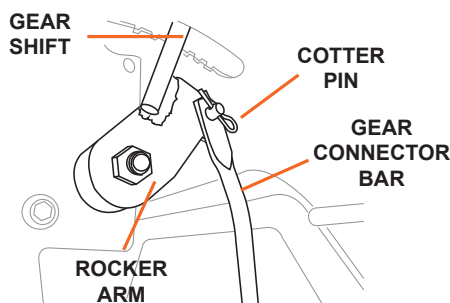

Figure 4

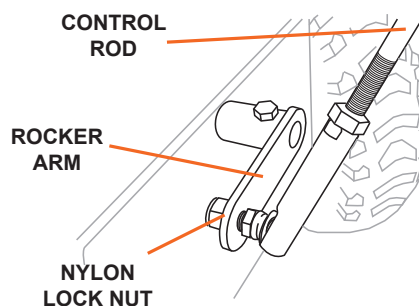

Figure 5

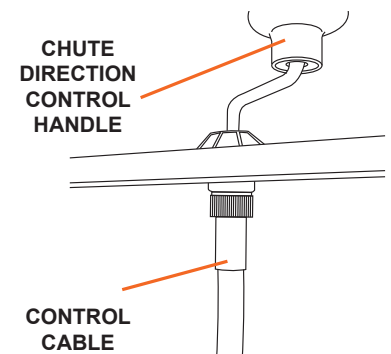

Figure 6

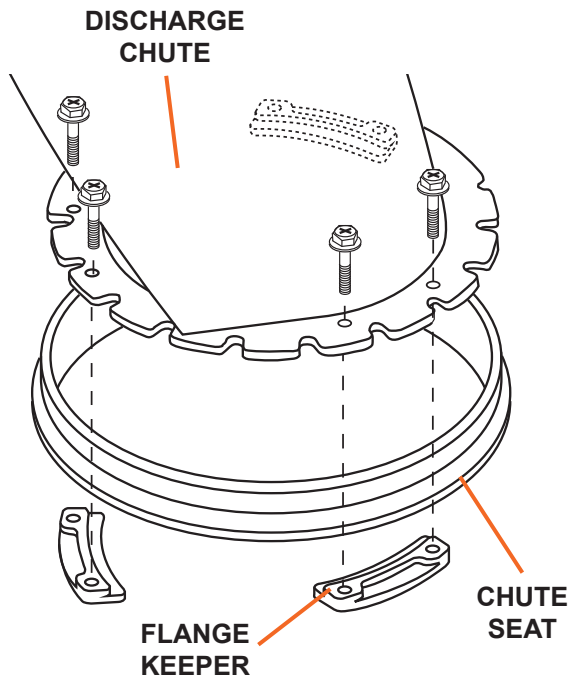

Figure 7

Attaching the Discharge Chute

1. Attach the discharge chute to the snow blower by placing it on the chute seat on the snow blower on top of the plastic friction ring. Position the flange keeper beneath the chute seat lip. Align the two holes in the chute and two holes in the flange keeper and secure with two bolts from the top side (see Figure 7). Repeat in three locations to attach the discharge chute to the snow blower.
2. Attach the chute crank bracket aligning the chute notches with the spiral end of the chute directional control assembly using the two hex bolts, flat washers and nylon lock nuts from the hardware kit (see Figure 8). Lubricate both ends of the chute directional control crank with petroleum jelly, paraffin wax, or light machine oil.

Attaching the Chute Height Control Cable

1. Attach the chute height control cable to the bracket underneath the control panel. Route the cable through the notch in the bottom bracket and tighten the two hex nuts on the top and bottom of the bracket. Then attach the cable end with the screw eye to the post on the upper bracket and secure with a R-clip.

NOTE: It will be easiest to attach the screw eye end of the cable to the bracket post when the chute height control knob is in the highest position (pulled towards the operator).

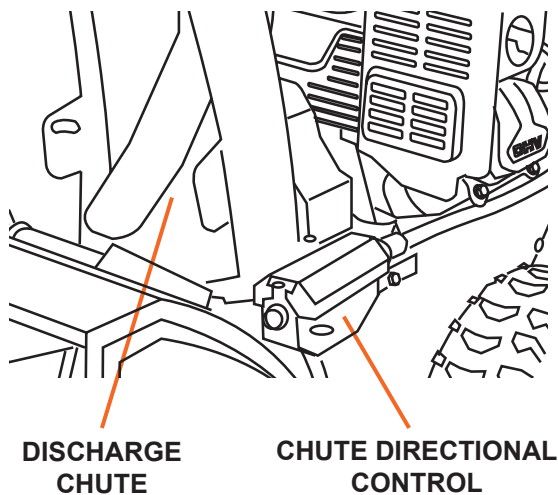

Figure 8

Attaching the Wheels

1. Attach both wheels by lining up the holes in the rim with both holes in the axle and securing with the attached d-rings.

Adjusting the Skid Shoes

1. Position the skid shoes based on surface conditions. Adjust upward for hard-packed snow. Adjust downward when operating on gravel or crushed rock surfaces. Loosen the two hex nuts that retain the skid shoe in place and move up or down as desired, then re-tighten the lock nuts (see Figure 9). Repeat for the opposite side of the snow blower.

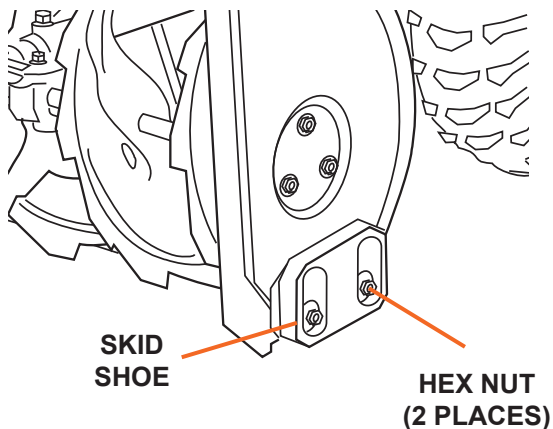

Figure 9